

LUGICAP SNOW

Owner's manual

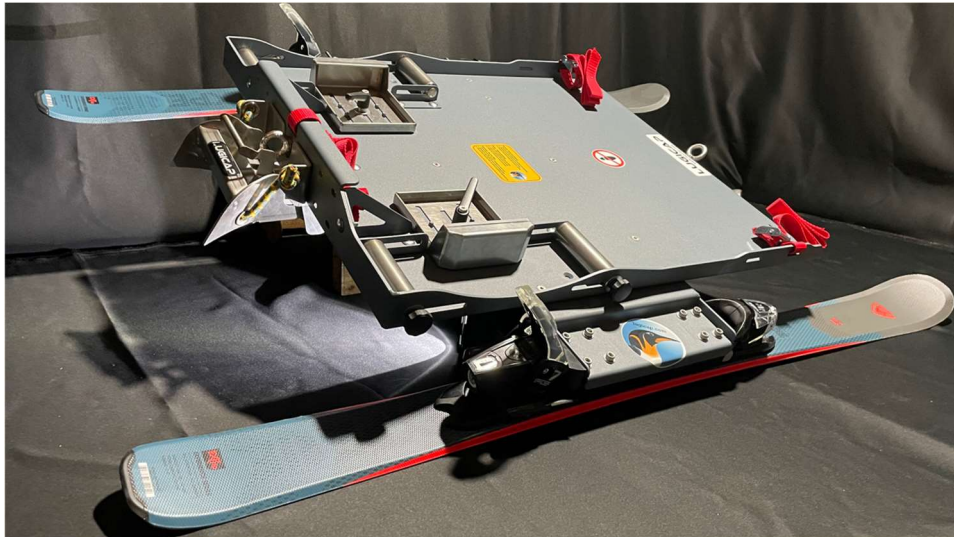

“Lugicap’s raison d’être is to allow every person with reduced mobility to have access to sports leisure; for a walk with friends, a moment of ice skating with the family or the most committed endurance races for people with disability”.



Frédéric Martin, chairman of LUGICAP

Welcome aboard!

You have just acquired a **Lugicap equipment for people with reduced mobility**, we congratulate you! By choosing **Lugicap**, you opt for products adapted to you, durable, and that generate life-size emotions. We are confident that you will fully enjoy the experience that our products make possible, it's up to you!

Our requirements when we think of a new equipment are as follows:

- 1 – Safety and Comfort for the user with disability and accompanying people
- 2 – Well-being and pride of the user and his family circle.

We hope you enjoy using your new **Lugicap** equipment as much as we enjoyed designing it for you. This manual will provide you with all the necessary operating and maintenance information, as well as safety recommendations. Read this manual entirely before practicing, and keep it for future reference. If some of the instructions are not clear to you, do not hesitate to contact us for further information.

Contact : contact@lugicap.com

Table des matières	Page
▪ Welcome	1
▪ Table of contents	2
▪ About us	3
▪ About you	3
▪ Safety first	4
▪ Environmental protection (ROHS, REACH)	5
▪ Declaration of conformity	5
▪ Product identification	5
▪ Compatibility with your wheelchair	6
▪ Before your first outing	6
▪ Before every outing	7
▪ Storage	7
▪ Limitations of liability	7
▪ Warranty	7
▪ Maintenance	8
▪ Lifespan and recycling	8
▪ Dimensions	9
▪ Visually impaired	9
▪ LUGICAP SNOW – Snowing activities	10
• Unpacking	10
• Safety accessories	10
• Other accessories	10
• Assembly	11
• Put on skis	11
• Settings	12
• Loading the wheelchair	13
• Installation of the clamping straps	15
• Installation of the disabled person	17
• Unloading the wheelchair	17
• Safety accessories	19
• Lifeline	19
• Safety Harness	20
• Other accessories	20
• Traction lanyard	20
• Traction harness	20
• Carrying bag	21
• Specific maintenance and spare parts	21
• Matérovigilance	21

About us



Frédéric Martin has been marketing his own inventions through a sole proprietorship “FM Concepts” since 2009. Strengthened by this experience, to keep expanding his vision of access to leisure for all, he created **Lugicap** with his friend Franck Emeyriat in 2021.

Frédéric is quadriplegic following an accident in 1993. In those days, faced with the difficulty of moving his wheelchair in the ski resorts where he was staying with friends, he thought of a sled on which a person in a wheelchair would take place to slide on the snow...

With his invention (1st prize at the Lépine innovation contest), he crossed Jura (France) in 2009.

Accompanied by two friends, he followed the route of the famous cross-country ski race “Transjurassienne”. They covered 68 km (42.25 mi) in a progress of 7 days all by themselves (nights in a tent down to -20°C or -4°F included).

This achievement then received wide recognition from the many supporters of the adventure, as well as media coverage commensurate with the feat.

After verification, nothing of the kind had ever been accomplished so far... A world first for a quadriplegic person!

The challenges of mobility, autonomy, climatic conditions... and the ones he had set for himself were met.

Lugicap’s DNA comes from this experience... and many others.

Today we are willing to share our experience and skills through our equipment: designed by us only, for you only.

More info here: www.lugicap.com

About you

LUGICAP equipment is intended for anyone with reduced mobility suffering from motor, sensory or cognitive disorders. All LUGICAP equipment is designed to directly accommodate the daily (manual) wheelchair of the disabled person; thus avoiding a seat transfer which often proves uncomfortable and complex for those accompanying you.

Each human being is particular, each disability having its own particularities, the practice of leisure sports activities must absolutely be adapted according to the person with a disability, and the experience in managing the disability of those accompanying them.



Safety first

Lugicap makes every effort to design and deliver safe products adapted to your disability. As for any other sports practice, the activities made possible by **Lugicap** equipment may cause risks. The users of **Lugicap** equipment and their accompanying people must be aware of these risks and assume them fully.

Every human being is special, every disability has its own particularities, the practice of sports or leisure activities absolutely must be adapted according to the person with disability him/herself, and to the experience in disability management of the people accompanying them.

Whether they are seated in their own chairs or in our ergonomic seat, people with disability must be wedged into their seats, and secured by our safety harness.

It is the responsibility of the accompanying people to ensure that the person with disability is safety seated.

When practicing with children, it is the responsibility of an adult to make sure that safety is ensured for all: users with disability and accompanying people.



The activities associated with **Lugicap** equipment must be carried out by at least two people: a person with disability and an accompanying adult who comes of age and who is independent.



The installation, adjustment and dismantling of the **Lugicap** equipment must be carried out by an adult, an independent person who accompanies the user with disability.



Check or have checked all the elements of your equipment before practicing. Do not go sledding with missing, damaged or defective components.



A precise recognition of the environment must be done by the accompanying person before practicing. Make sure that the ground, the weather conditions and any other element that could lead to a danger for the user and the accompanying people are favorable to a safe practice.



Make sure you have the necessary access authorizations when practicing on regulated areas (ski slopes, ice rinks, private land, etc.)



Adapt your practice and behavior according to:

- The physical condition of the user with disability and the one of the accompanying people
- The type of disability
- The level of motivation of all the participants
- The Environment: climate and weather conditions, nature of the ground
- Any particular situation



It is recommended to train and handle your new **Lugicap** equipment before undertaking more advanced practice.



Do not practice under the effects of alcohol, drugs or medication. This could impair your judgment, reflexes and lead to a dangerous situation for the user and the accompanying people.



Do not carry luggage or other bulky items on your equipment when you are practicing. Apart from potentially disturbing the balance of the whole set and its efficiency, this could lead to a dangerous situation by hindering progress.



Veil Be careful not to get carried away by speed, control it and adapt your practice.



Do not venture into dangerous practices such as jumps or descents without speed control.



Avoid practicing at night in order to preserve your ability to see while it is still light.



Choose appropriate clothing for the activities you are practicing: protect yourself from cold, humidity, rain, wind and sun.



To avoid possible collisions, make sure you are visible to others when practicing (e.g., by wearing showy clothing, reflective armbands and/or a safety flag).



Only the person with reduced mobility must be installed on the Lusicap equipment; Accompanying people, whether adults or children, must not ride on the sled or on the wheelchair during practice.

Environmental protection (ROHS and REACH)

In a sustainable development approach in which **Lusicap** fully adheres, we pay particular attention to the environmental impact that results from our activity.

- **Lusicap** products comply with European Union directives:
 - ✓ ROHS (*Restriction of hazardous substances*)
 - ✓ REACH (*Registration, Evaluation, Authorization and Restriction of Chemicals*)

Declaration of conformity

Lusicap products comply with the requirements of current European standards and directives.

- EU directive 2017/745
- ISO 9999: 2016 – Assistance products for people with disability

Identification du produit

- Your **Lusicap** equipment has an identification code in the form of a bidirectional bar code (data matrix). Scanning this code leads to this instruction manual.



- Your **LUSICAP** equipment also has a serial number on the identification label which can be found underneath the device. If you wish to upgrade your product or replace a damaged component, this serial number will tell us which parts fit your product.

Compatibility of **Lugicap** equipment with your wheelchair

Lugicap equipment is adapted to accommodate the vast majority of manual wheelchairs. Wheelchairs used on LUGICAP equipment must be CE marked. **Lugicap disclaims all liability in the event of the use of wheelchairs without CE marking.**

If you notice an incompatibility between your wheelchair and Lugicap equipment, do not insist so as not to damage your wheelchair. If in doubt, contact us.

 **NOT SUITABLE FOR ELECTRIC WHEELCHAIRS!**

Permissible dimensions and load:



Min.: 42 cm (16.54 in) Max.: 130 kg (286.6 lb)

Max.: 60 cm (23.62 in) (Wheelchair track width: outside dimension of the rear wheels at ground level)

If your chair is out of these dimensions, please contact us, we have solutions!

Before your first outing

You are about to enjoy your first experience with **Lugicap** equipment...

In order to ensure maximum enjoyment and safety, please follow these instructions carefully before your first outing:

1. Read or have read this instruction manual entirely before you start the activity. Make sure you understand all the instructions and recommendations in this manual.
2. Familiarize yourself with your equipment, learn how to set it up optimally for your configuration and use.
3. Make sure your equipment is **complete** and has no damaged parts.
4. Get on the equipment by following the step-by-step instructions in this manual.
5. Practice on a flat, open ground.
6. Adjust the settings again if necessary.
7. You are ready now to enjoy your first outing!



Make sure your wheelchair (if applicable) is properly wedged in the equipment.



Make sure that your wheelchair is held tightly to the equipment with the supplied clamping strap before any moving.



Depending on the type of disability, we recommend the systematic use of our safety harness or any other appropriate means to keep the person well positioned in the wheelchair and thus spare him/her from falling out.



For safe practice, use the provided lifeline to tie the accompanying person's wrist to the adaptive sled.

Before every outing

1. When unpacking, check that your equipment has been stored properly and has not deteriorated.
2. Check that it is complete and does not have any damaged parts from previous outing.
3. Check the tightness of the different elements of your equipment.
4. Get on board!

Storage

- Protect your equipment with a **Lugicap** cover or the original carton
Both solutions are effective, even for a long-term storage.
- Store your equipment in a dry place at temperatures between - 30°C and +50°C (-22°F and 122°F)
- Do not pile heavy loads on your equipment, whether it is packaged in its original packaging carton OR in a cover.

Limitations of liability

Lugicap shall not be held liable for damages of any kind, whether material, immaterial or physical, that may result from:

- A misuse of **Lugicap** products
- A dangerous practice for the users or the accompanying people
- Noncompliance with the instructions and recommendations detailed in this manual
- Any use not in conformity with the use of the equipment
- Any cause of external origin
- The use of manual wheelchairs without CE marking

Lugicap informs the owner that the practice of sports leisure may cause risks and dangers the latter must completely assume. The owner hereby waives all claims and proceedings against **Lugicap** for any loss, damage or injury suffered by the user.

This applies before, during and after the use of the **Lugicap** equipment.

Lugicap shall not be held responsible for any mechanical or aesthetic deterioration of a wheelchair resulting from any use not in conformity with this instruction manual.

Warranty

Because we believe that consumerism is not a reasonable solution, we make sustainable products. The quality of our products is therefore at the center of our priorities, so that you can enjoy them for a long time, safely.

Lugicap equipment is guaranteed for 2 years against any manufacturing or material defects.

As part of the warranty, the defective parts will be replaced free of charge after expertise of the material by the **Lugicap** team in order to identify the nature of the failure and to confirm or deny any responsibility of **Lugicap**.

The parts to be replaced under the warranty then become the property of **Lugicap**.

- The shipping costs for the material to be replaced by **Lugicap** are the responsibility of the customer.
- The costs of returning the repaired equipment are the responsibility of **Lugicap**
- ✓ Non-compliance with the instructions and recommendations detailed in this manual will void the warranty.
- ✓ Any modification from the original condition of **Lugicap** equipment will void the warranty. Only an equipment equipped with genuine **Lugicap** parts is covered by the warranty.
- ✓ The purchase invoice for the equipment is a proof of purchase and ownership.
- ✓ In case of resale of the equipment, the warranty is transferable to the next owner (a deed of assignment will be requested by **Lugicap** in case of any request for warranty).



General maintenance

In order to enjoy your **Lugicap** equipment for a long time, it is necessary to carry out maintenance and regular checks.

After every outgoing (and before storage):

- Dry and store the safety harness, lifelines, traction harnesses, etc.
- When used in a saline environment, rinse the equipment thoroughly with clear water.
 - Info: the paint of the **Lugicap** equipment is qualified for 500 hrs. in a saline atmosphere
- Dry and clean your equipment with a soft cloth.
- Check that no parts have loosened during the outing. If necessary, tighten with a hand tool (do not use electric or pneumatic hand tools).
- Disassemble the removable elements if necessary: rear handlebars, seat etc...
- Store your equipment in a **Lugicap** cover or in its original packaging carton.



Lifespan and recycling

The feedback we have from our products in the field, combined with laboratory tests*, indicates a lifespan of 8 to 10 years in moderate use (between 10 and 15 outings per year), excluding wear parts and accessories, and under normal conditions of use.

At the end of its life, the equipment must be placed in a recycling center to be recycled, or returned to us so that we can take care of this recycling.

Our products are tested in the laboratory with a mannequin conforming to the ISO7176-11 standard (112kg mannequin).

Tests carried out at CERAH (Center for Studies and Research on Equipment for disabled people)

REF Dimensions

Modèle	Largeur (mm)	Profondeur (mm)	Hauteur totale (mm)	Hauteur sol / plateforme (mm)	Poids (kg)
ICE PERF	610 (max)	740	140	50	7,5
ICE	610	740	100	50	9
SNOW	810	800	210	160	12,5*
					*Hors skis

Visually impaired



If you suffer from visual impairment, this document can be consulted in pdf format on www.lugicap.com, or sent to you in large print, on request.

LUGICAP SNOW – Activities on snow

- Suitable for people with reduced mobility suffering from any form of pathology equipped with a 3 or 4 wheel manual wheelchair.
- Accompanists must wear good shoes in order to operate the sled in the best conditions:
 - Hiking shoes
 - Snowshoes (optional)
- Lugicap Snow is designed for mobility, walking or hiking on snow on flat or hilly terrain (Maximum slope inclination = 20% or 11°)
- On flat ground, a companion is sufficient (he then places himself at the back, and pushes the sled).
- In case of climbs: One guide tows the sled with a traction harness, and a second equipped with a lifeline places himself behind the sled to ensure the safety of the boat. Max slope 20% or 11°
- During descents: The two guides, one of whom is equipped with a lifeline, position themselves at the rear of the sled in order to control the speed of descent. Max slope 20% or 11°
- Lugicap Snow is not designed for downhill skiing!
- Lugicap Snow is modular, the “Ice” kit allows you to transform your snow activity sled into an ice skating sled, and vice versa!

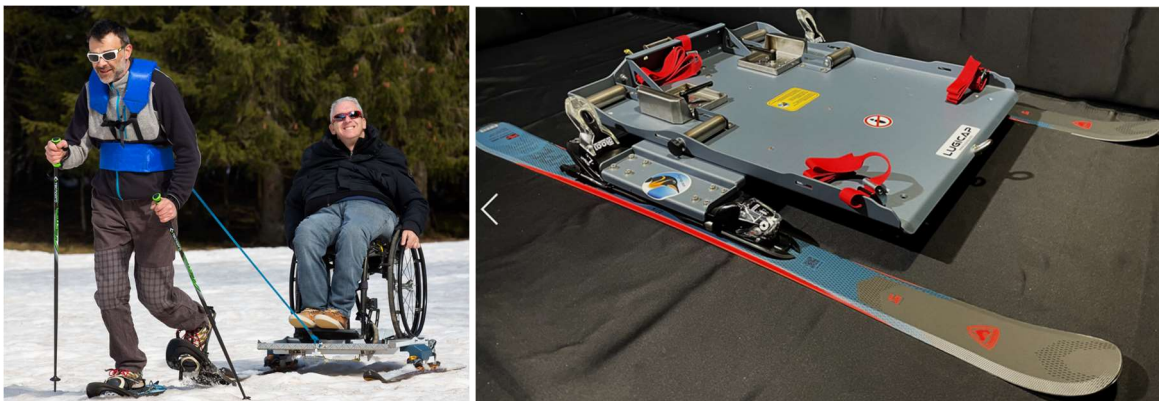

Unpacking

- Upon receipt, check the integrity of the packaging boxes before opening them.
 - If a box is damaged, refuse it to the carrier.
- Open the packaging boxes with a cutter, taking care not to damage them. Lugicap packaging boxes are designed to last, they will help you store your equipment efficiently.

Safety accessories

- 1 safety leash (mandatory)
- 1 safety harness (recommended)

See the chapter dedicated to safety accessories for recommendations for use

Other accessories

- Traction harness (recommended)
- Traction lanyard (recommended)
- Carrying case (nice to have)

See the chapter dedicated to accessories for recommendations for use

Assembly

Lugicap Snow is delivered assembled, ready for putting on the skis and the settings.

Putting on the skis

Lugicap Snow wear standard binding skis (the skis are supplied by Lugicap).

The skis are factory adjusted by LUGICAP in order to comply with the sled. Thus the bindings correspond to the size 42 of a ski boot, they are also adjusted as tight as possible.

1. Position the skis parallel on flat ground.
2. Engage the front shoes of the sled in the front bindings of the skis (Fig.0)
3. Check that the ski bindings are in the “ready to put on” position (Fig.1)
4. Push the rear of the sled downwards to engage the rear ski bindings (Fig.2)



Fig.0



Fig.1



Fig.2

5. Check that the skis are properly fitted (as with any ski fitting, the front and rear shoes must be correctly engaged in the bindings (Fig.2)

Settings

○ Wheel stops adjustment

The wheel stops must be adjusted according to the diameter of the wheels of the wheelchair to be loaded.

The larger the wheel, the farther apart the stops must be; Conversely, the smaller the wheel, the closer the stops are to each other.

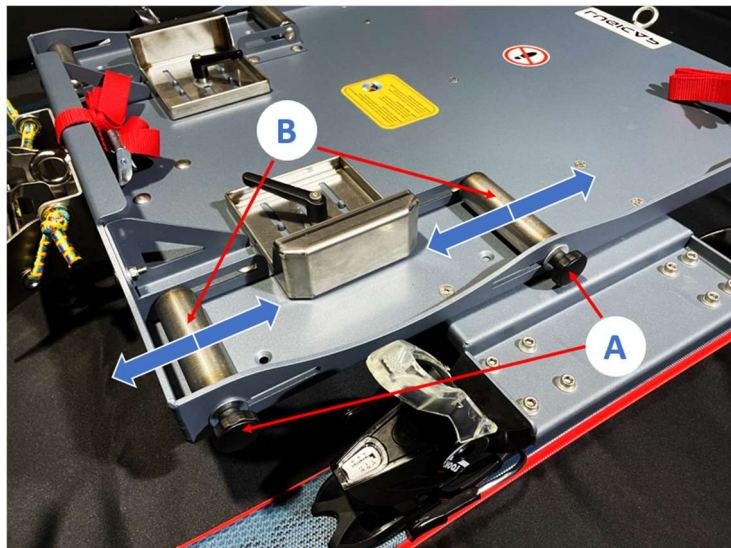

Fig.3

1. Loosen the knobs A, so as to release the stops B (Fig.3)
2. Adjust the stops B then tighten A manually to the maximum (Fig.4)
3. Repeat the operation on each side of the sled

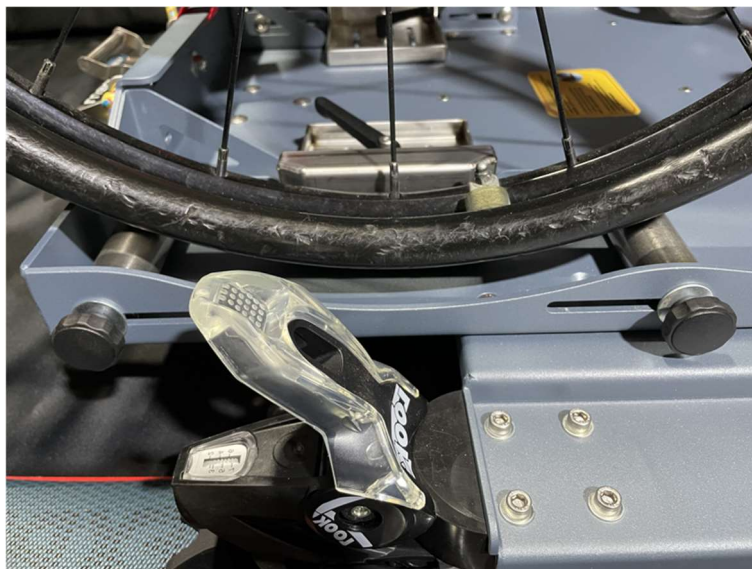

Fig.4

Loading the wheelchair

1. Loosen the handles C* by a quarter turn to release the wheel flanges D. Bring the two flanges D to the center of the platform to leave plenty of room for the chair to pass through (Fig.5)

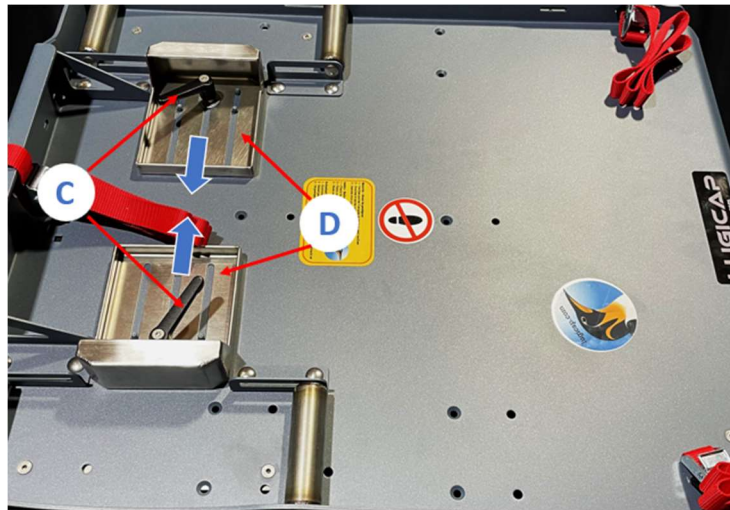

Fig.5

*The handles are indexable; by lifting the black part, it is possible to reposition it without affecting the tightening.

2. The attendant immobilizes the sled by activating the parking brake with his foot (Fig.6) Depending on the nature of the snow (groomed, powder or ice), it is possible to lower the brake more or less, it then locks in one of the 4 depth adjustment notches.



Fig.6



Brake in "activated" position

3. The attendant presents the wheelchair with his back to the front part of the equipment in order to prepare for loading (Fig.7)

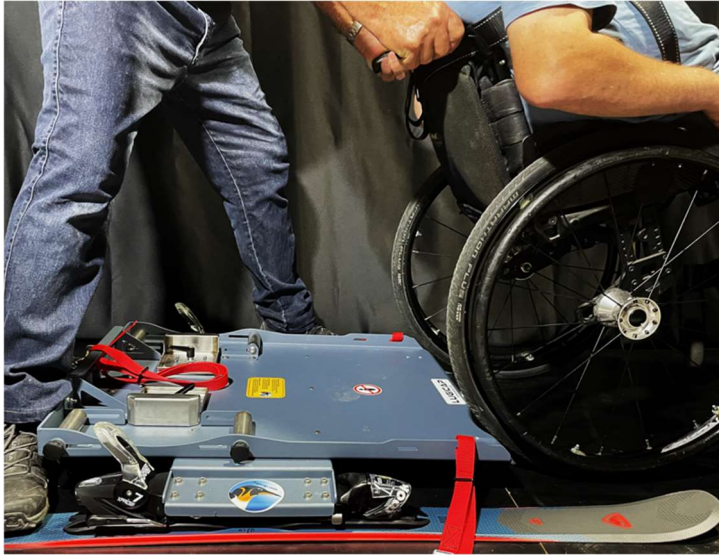

Fig.7

4. The attendant tilts the chair onto its rear wheels and boards the sled (Fig.8)



Fig.8

5. The rear wheels of the wheelchair fit into the previously adjusted wheel stops (Fig.9)

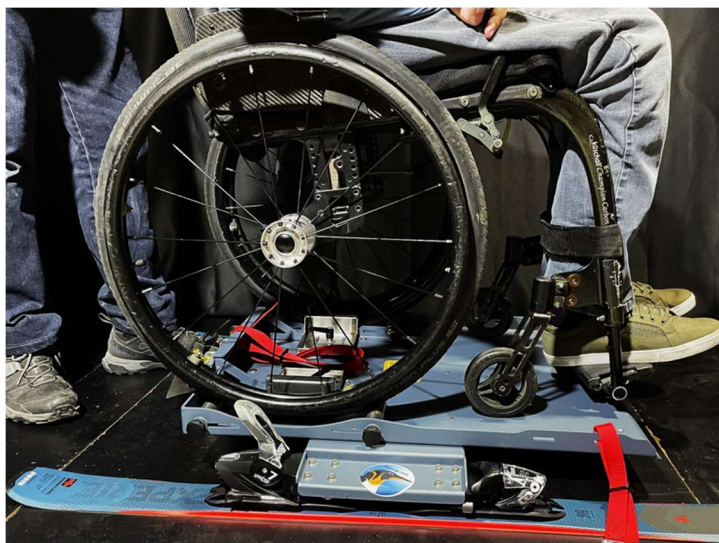

Fig.9

6. Fit the wheel flanges D against the inside of the wheelchair wheels (see Fig.10)
Tighten the handles C* firmly (manual tightening only) to immobilize the assembly (repeat the operation on each side)

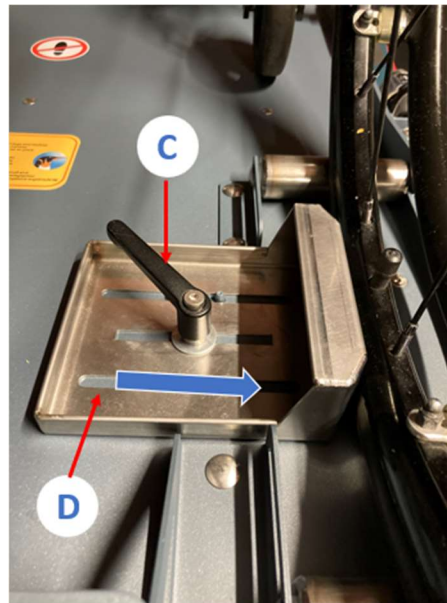

Fig.10

The wheelchair is now held sideways.

*The handles are indexable; by lifting the black part, it is possible to reposition it without affecting the tightening.



Depending on the experience and comfort of each person, it is recommended to board the wheelchair with the help of 2 attendants (one located at the back of the wheelchair and the other located in front), in order to completely secure the wheelchair's boarding.

Installing the clamping straps

In order to secure the chair and the equipment, the sled is equipped with a rear clamping strap and two side clamping straps (Fig.11)

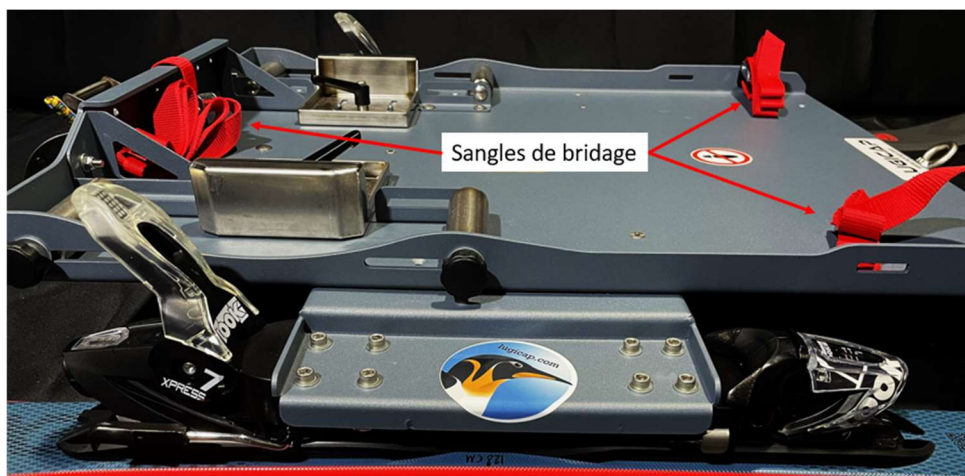

Fig.11

1. Installing the rear clamping strap

- Pass the strand of strap fitted with the quick release buckle over the tubular part of the chair, under the seat; as shown (Fig.12)
- Pass the remaining strand through the quick loop
- Tighten the strap by pulling the strand downwards as indicated (Fig.12)
- Make sure the strap is now tight
- Carefully tie off the remaining slack so that it does not hinder the progress of the boat

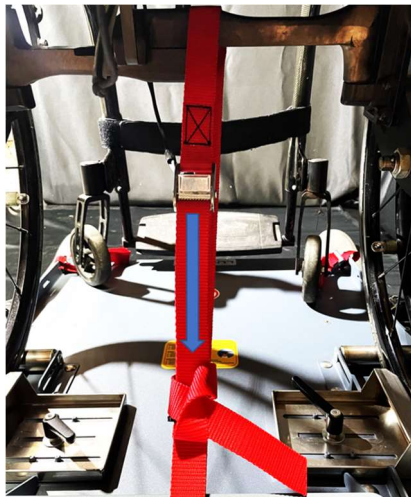

Fig.12

2. Installing the side straps

- Pass the strap strand equipped with the quick buckle over the wheelchair wheel attachment, or other depending on the wheelchair (Fig.13)
- Pass the strand of strap through the quick buckle then tighten it as much as possible by pulling downwards (Fig.14)
- Make sure the strap is now tight
- Tie the strap neatly so that it does not hinder the progress of the boat (Fig.15)



Fig.13



Fig.14



Fig.15

- Repeat the operation on the 2 side straps (left and right)

3. Check again that the 3 straps are tight and that the wheelchair is now firmly held on the sled.



During the activity, regularly check that the restraining straps are still tight.



Replace the straps on your equipment with original Lugicap straps every 5 years or if they start to fray (after very intensive use or prolonged exposure to UV and bad weather)

4. Before leaving, unlock the parking brake by hand using the upper lever (Fig.16)



Fig.16

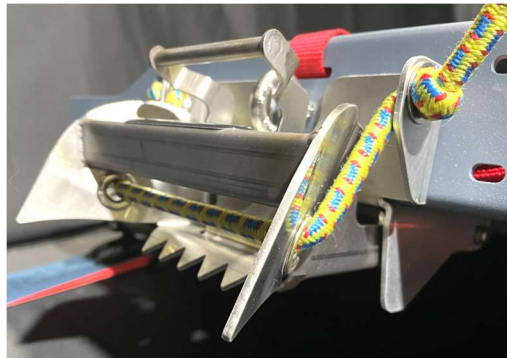

Brake in "up" position

Installation of the disabled person

You must be well supported and supported in the wheelchair in order to enjoy the experience 100%, in a secure environment. We strongly recommend the use of a harness to hold the person with a disability in their seat. The one we offer is easy to use, adjustable and safe (see the "safety accessories" chapter).

Unloading the wheelchair

1. Immobilize the sled and activate the parking brake
2. Remove the clamping straps and release the wheel clamps D by loosening the levers C
3. The attendant lifts the chair by its handles to disengage it from the stops (Fig.17)
4. The attendant tilts the chair onto its rear wheels then disembarks (Fig.18 and 19)



Fig.17

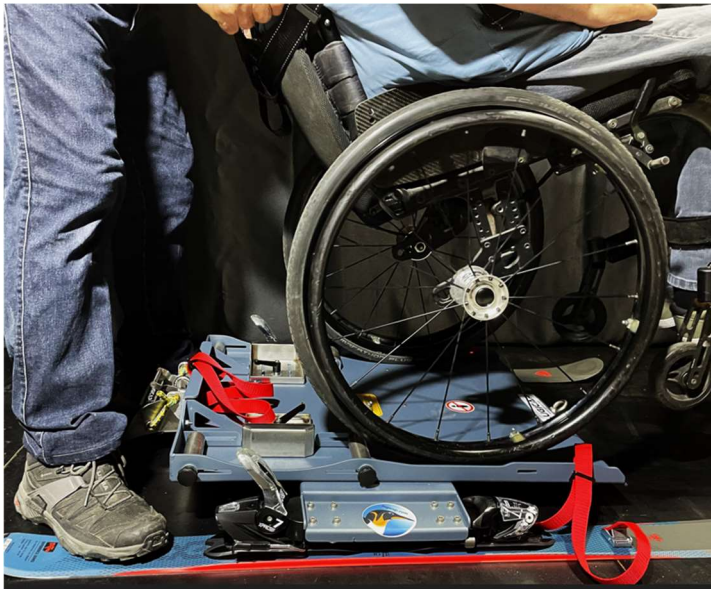

Fig.18



Fig.19



Depending on the experience and comfort of each person, it is recommended to board the wheelchair with the help of 2 attendants (one located at the back of the chair and the other located in front), in order to completely secure the unloading.

5. Removing skis

To remove the skis from the platform, push on the rear bindings as shown below



Safety accessories

For safe practice of the activities that Lagicap makes possible, the use of a lifeline is mandatory, we also recommend the use of a support harness.

Lifeline (mandatory)

The lifeline connects the attendant's wrist to the sled as indicated (Fig.20)

Thus, even if the attendant lets go of the chair, it is still connected to the sled (Fig.21)

The lifeline must remain in place for the entire duration of the activity, including when it stops.



Fig.20



Fig.21

Safety harness (recommended)

The safety harness must be perfectly adjusted (thanks to the adjustment buckles (Fig.23) in order to keep the person with reduced mobility in their wheelchair.

The harness is passed through the handles of the chair to create 2 anchoring points (Fig.22)



Fig.22



Fig.23

Other accessories

Traction lanyard (recommended)



1.9m traction lanyard, equipped with 2 carabiners



This lanyard is designed to tow Lagicap equipment only.



Do not use for hanging, climbing or towing anything else.

Traction harness (recommended)

This harness of our design (made in France) allows you to tow a Lagicap SNOW efficiently. Easy to use, efficient and comfortable, it will meet your requirements.



To tow uphill safely, it is necessary for a second attendant equipped with the lifeline to position themselves behind the wheelchair.

During descents, the 2 guides position themselves at the rear of the sled in order to control the speed and possibly stop the sled when necessary.

Carrying bag (nice to have)



Our transport covers are custom made by our local supplier.

Very resistant, this cover constitutes the best protective solution for transporting and storing your equipment.

Specific maintenance and spare parts

The skis fitted to Lugicap Snow can be waxed and sharpened like any other ski.

For an optimal sliding experience, it is recommended to wax and sharpen the skis once a year.

In case of intensive use, check the condition of the chassis at the end of each season and in particular the absence of deformation or cracking. Contact us if in doubt.

If, however, you damage your skis irreversibly, such as tearing off an edge on a stone for example, replace them with skis supplied by LUGICAP, these are sized and adjusted specifically for the use of Lugicap Snow.

Furthermore, Lugicap has at your disposal any part that makes up your Lugicap Snow in the event of damage or loss of one of them.



Matérovigilance

Users can report any incident or risk of a serious incident - Professional users and manufacturers of medical devices must report any incident or risk of a serious incident without delay - Your report will be transmitted to the national medicines and product safety agency de santé, the organization responsible for monitoring medical devices. It evaluates reports and takes preventive or corrective measures if necessary.

signalement-sante.gouv.fr (regarding medical devices)

LUGICAP

LUGICAP SAS
2 rue de la fontaine
70190 Buthiers
France

www.lugicap.com

Contact commercial :

Frank Emeyriat : +33 (0) 6 72 69 98 74

Email : frank.emeyriat@lugicap.com

